

# THE WORCESTER



## 3 Bedroom Semi Detached House

The Worcester is a 3 bedroom home to suit both couples and young families and is perfect for first time buyers stepping on to the housing ladder.

The hallway leads to the kitchen & dining area and the light and airy living room with french doors leading out to the rear garden. The guest cloakroom and an under stair cupboard to the hallway complete the ground floor.

Upstairs the landing leads to the well-proportioned master bedroom. A further bedroom, the family bathroom with separate shower and a bedroom which could alternatively be used as a study or nursery are also on the first floor.

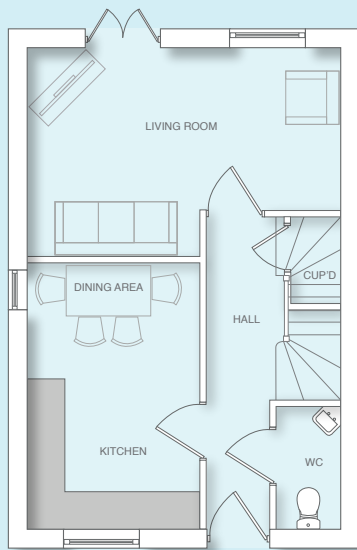

### Ground Floor

Living Room	5010 x 3335 mm max
	16' 5" x 10' 11"
Kitchen & Dining	2755 x 4250 mm
	9' 0" x 13' 11"
Guest Cloakroom	1957 x 1040 mm
	6' 5" x 3' 10"

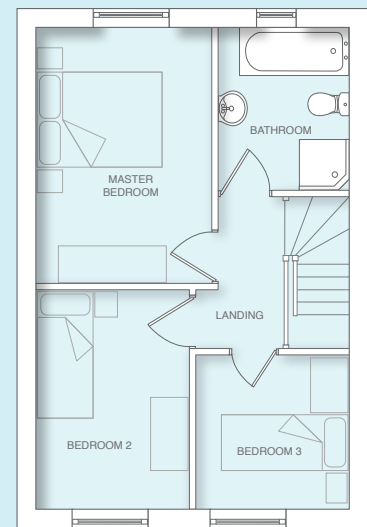

### First Floor

Master Bedroom	2810 x 4085 mm
	9' 2" x 13' 5"
Bedroom 2	2455 x 3500 mm
	8' 0" x 11' 5"
Bedroom 3	2455 x 2460 mm max
	8' 0" x 8' 1"
Bathroom	2100 x 2600 mm
	6' 10" x 8' 6"



[www.broadgatehomes.com](http://www.broadgatehomes.com)

This image is from an imaginary viewpoint within an open space area. Its purpose is to give a feel for the development, not an accurate description of an individual property. It shows a typical Broadgate home of this type, but external materials and landscaping may vary throughout the development and from site to site. Certain windows are subject to plot position on site. Properties may also be built handed (mirror image).

The floor plans depict a typical layout of this housetype. All dimensions are + or - 50mm and floor plans are not shown to scale. For exact plot specification, details of external and internal finishes, dimensions and floor plan differences always consult your Sales Negotiator. CF17/829/C1